



General access information

London office

Our central London headquarters overlooks both The Tower of London and St Katharine Docks. We're a short walk from Tower Hill Tube station, and within easy reach of Liverpool Street, Fenchurch Street and London Bridge.

You can find us at

Tower Bridge House
St Katharine's Way
London
E1W 1AA

DX: 7842 Bristol
T: +44 20 3060 6000
F: +44 20 3060 7000

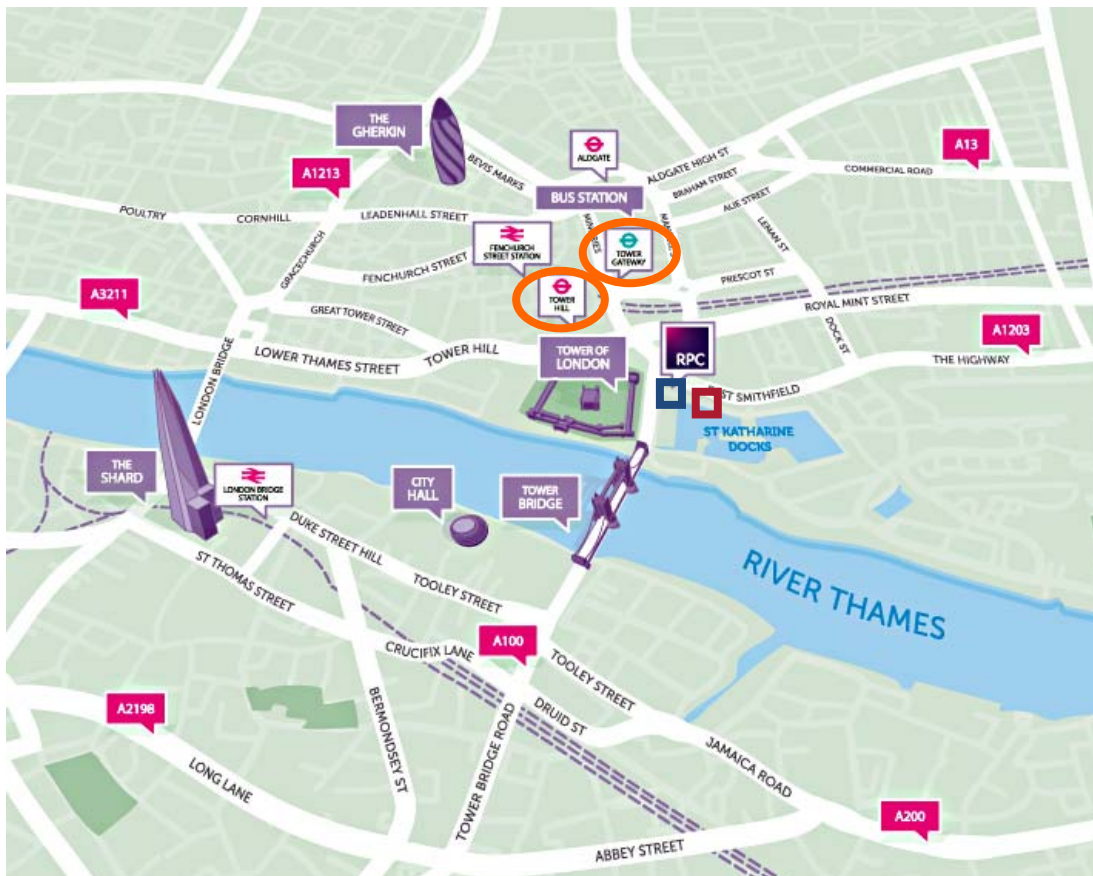

- **Red box:** step free access
- **Purple box:** Tower Bridge House Parking Entrance. Car access into loading bay from E Smithfield Road. Using postcode E1W 1AN in a satnav works better than office postcard (E1W 1AA)
- **Orange circles:** nearest train stations
- **Red box:** taxi rank

Nearest station (distances to office entrance)

- Tower Hill Underground Station is step free from platform to street level (0.2 miles)
- Tower Gateway is step free from platform to street level (DLR) (0.2 miles)
- Aldgate Underground Station is step free from platform to street level (0.6 miles)



- **Black line:** step-free route from Tower Hill Station to office entrance
- **Red line:** step-free route from Tower Gateway Station to office entrance
- There are two main walking routes from Tower Hill station to the office – one which is overground and one which follows the underpass. Both routes can be very busy as they pass by the Tower of London and Tower Bridge which are popular sites to visit in London. There is also a main road leading to Tower Bridge which can be very busy with traffic and quite loud.

Overground route

- Upon coming out of the gates at the station, walk straight ahead out the exit and take a left at the red “Tower Hill Tram” refreshments van, walking towards the Tower of London (which you should be able to see straight ahead of you).
- Walk down the steps towards the crossing, and once across the road, turn left. You should then be walking parallel to the Tower of London (which will be on your right hand side).
- Continue walking, following the road which curves round to the right. You will pass some Santander bikes for hire on your right and a statue of a construction worker on your left.
- Follow the road round, turning around the corner until you reach a crossing where you will see our glass building across the road, and the start of the Tower Bridge to your right.
- Cross over to our building using the pelican crossing, and enter using our main entrance.
- Please note this route can be very busy.

For step free access

- When coming out of the station, turn left, passing the blue crepes and waffles stand (this should be on your right).
- Stay left, passing through the bollards and along the pavement – there will be shops on your left and a playground on your right.

- Continue to the end of the road, and turn to cross the road on the right where you will see a pedestrian crossing. Opposite you, you will see the Tower of London slightly off to the right, along with the Shard. Our glass building will be slightly off to the left. Cross towards this using the pedestrian crossings.

Underpass route

- Upon coming out of the gates at the station, take your first left and the next right down the short stairs before you reach the **blue** crepes and waffles stand.
- Walk straight past the Tower Hill Station entrance and go down the three flights of stairs to the underpass.
- Walk straight ahead under the bridge steering to the left. Follow the left route. You should be walking parallel to the Tower of London (which will be on your right hand side).
- Continue walking straight when you reach the second underpass. Do not go up the stairs on your right, this will take you to the main road.
- When you have come out of the second underpass, you will see the Dockside level entrance in the glass building straight ahead curving to your right.
- Enter using this entrance. You will need to press “**call**” on the intercom. Somebody in reception will open the door for you.
- Please note this route can be busy with people visiting the Tower of London or during rush hours. This route also has dim lighting in the dark hours.

For step free access

- When coming out of the station, turn left, passing the **blue** crepes and waffles stand (this should be on your right)
- Stay left, passing through the bollards and along the pavement – there will be shops on your left and a playground on your right
- Continue to the end of the road and follow the pavement round curving to the right. Go past the pedestrian crossing (which should now be on your left) and walk straight. You should be walking parallel to the Tower of London (which will be on your left hand side across the road).
- Walk past the first right turning, which leads into the Tower Hill Garden, and take the second right turn following the ramp downwards.
- When you have come to the end of the two ramps, turn right to go under the bridge and continue straight, steering to the left.
- Follow the left route. You should be walking parallel to the Tower of London (which will be on your right hand side).
- Continue walking straight when you reach the second underpass.
- When you have come out of the second underpass, you will see the Dockside level entrance in the glass building straight ahead curving to your right. Enter using this entrance. You will need to press “**call**” on the intercom. Somebody in reception will open the door for you.
- Please note this route can be busy with people visiting the Tower of London or during rush hours. This route also has dim lighting in the dark hours.

Nearest bus stops (distances to office entrance)

- TN St Katharine Docks, towards Liverpool Street (0.1 miles)
- TS St Katharine Docks, towards Wapping (0.2 miles)
- TE Tower Hill/Tower Gateway Station, towards Bricklayers Arms, Peckham, or Wapping (0.2 miles)
- TA Tower of London, towards St Paul’s (0.2 miles)
- TB Tower of London, towards Limehouse (0.2 miles)
- TC Tower Gateway Station, towards Liverpool Street or Moorgate (0.3 miles)

Parking (distances to office entrance)

- Minories Car Park (0.2 miles)
- City Quay Car Park (0.3 miles)
- NCP London Thomas More Square Car Park (0.4 miles)

RPC is located on Levels 1, 3 and 4 of Tower Bridge House and our main reception is located on Level 1 (street level). Tower Bridge House can be accessed through our main entrance along St Katherine's Way where there is step free access. The building can also be accessed dockside via a lift and escalators which will bring you up to main reception. This entrance is open from 0700 until 1900.



Street Level Entrance to the Building with step free access.



Street Level Entrance, reception on right, lifts straight ahead.



Street Level Entrance to the Building. RPC Reception located on the right. Access to our Ground 1 meeting rooms available through RPC reception.



Dockside Level Reception & lift up to main reception.

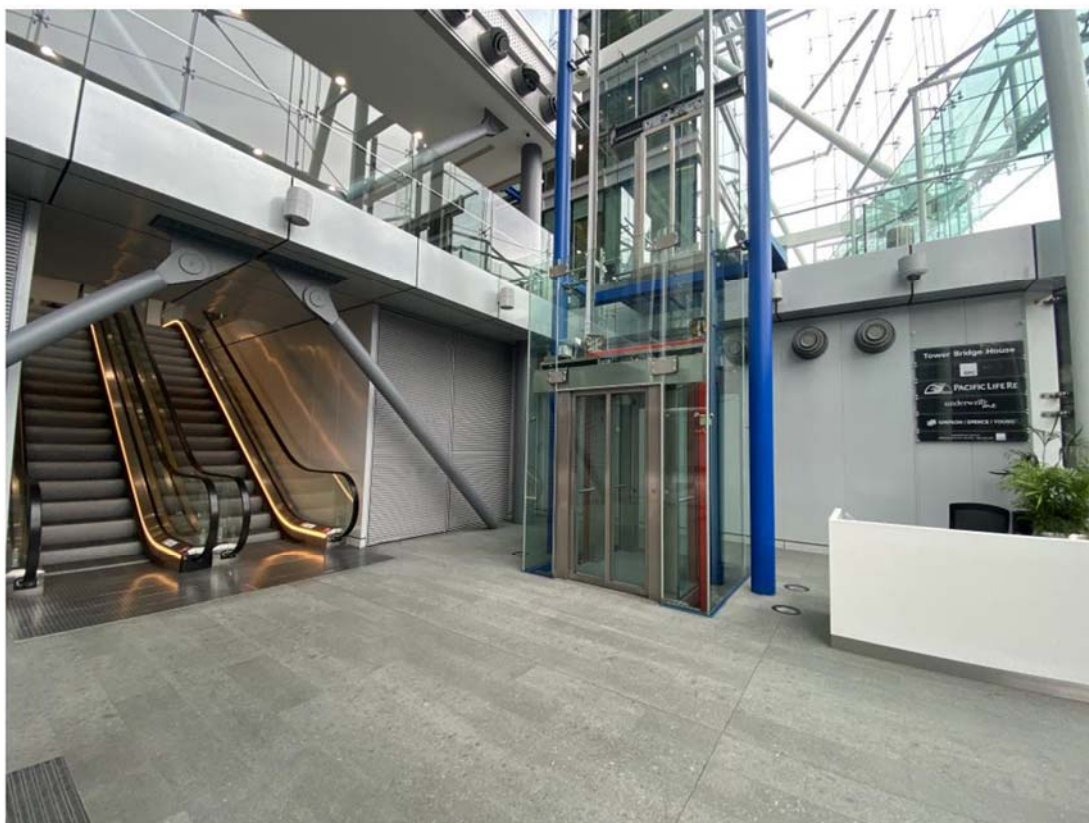

Lifts and escalators in Dockside entrance up to main reception.



Entrance Gates at main reception to access lifts.



Lifts up to our working floors (3 & 4).

If you have having trouble accessing the building, please contact:

- **RPC reception:** 07.30-19.00; +44 20 3060 6500
- **Main building reception 24/7:** +44 20 7680 4040

Reasonable Adjustments

If you need any reasonable adjustments or require any accessibility support, please do let us know by emailing our Facilities team and we will try and accommodate your requests.

Here are some examples of adjustments that can be made but we are always open to discussions on how we can best accommodate:

- **Hard copy presentation/materials:** handouts can be printed to replicate what is being show on screen
- **Hearing loop:** hearing loop is available in Reception
- **Text size/font:** increased text size or specific font available and potential to further enhanced with special technology
- **Time:** additional time may be incorporated into test situations
- **Wellbeing room:** quiet room available if needed.

All our lifts are glass. If you have a condition where you prefer not to use a glass lift, we have an alternative route via our goods lift. Please contact our Facilities team in advance to arrange this.

Contact

- **Facilities Helpdesk:** Facilities.Helpdesk@rpc.co.uk
- **RPC reception:** 07.30-19.00; +44 20 3060 6500
- **Main building reception 24/7:** +44 20 7680 4040